

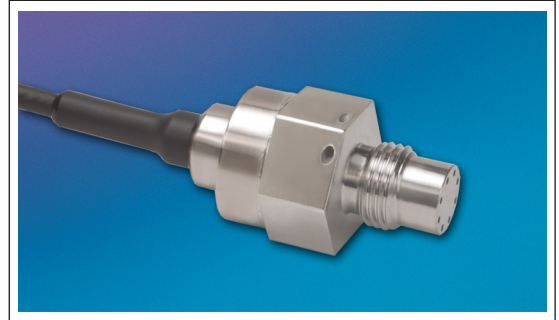

# MINIATURE HIGH PRESSURE PRESSURE TRANSDUCER

## HKM/HKL-233(X)-375 (M) SERIES

- Excellent Stability
- All Welded Construction
- Hermetic Sealed Package
- Robust Construction
- High Natural Frequencies
- Aerospace Quality Components
- "X" Identifies Electrical Connection Option
- Patented Leadless Technology VIS® (HKL Series)
- Thermorad Jacket Compatible With Most Aircraft Fluids
- Intrinsically Safe Applications Available (i.e. IS-HKM-233(X)-375)



The HKM/HKL-233(X)-375 is a miniature threaded pressure transducer. The hexagonal head and o-ring seal make it easy to mount and simple to apply.

The HKM-233(X)-375 utilizes a flush metal diaphragm as a force collector. A solid state piezoresistive sensing element is located immediately behind this metal diaphragm which is protected by a metal screen. Force transfer is accomplished via an intervening film of non-compressible silicone oil. This sensing sub assembly is welded to a stainless steel body.

The HKL-233(X)-375 utilizes Kulite's Patented Leadless Technology. A solid state piezoresistive sensing element is protected by a metal screen. This sensing sub assembly is welded to a stainless steel body.

This advanced construction results in a highly stable, reliable and rugged instrument with all the advantages of microcircuitry: significant miniaturization, excellent repeatability, low power consumption, etc. The miniaturization process also yields a marked increase in the natural frequencies of the transducers, making them suitable for use even in shock pressure measurements.

Kulite recommends the **KSC Series** of signal conditioners to maximize the measurement capability of the HKM/HKL-233-375 transducers.

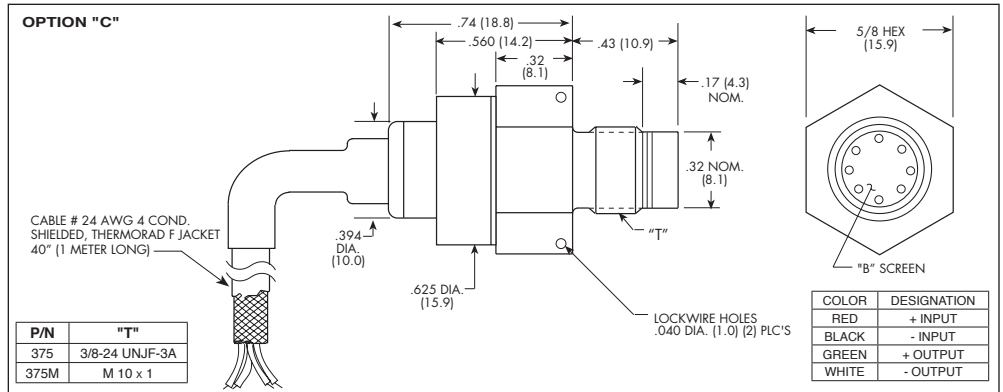
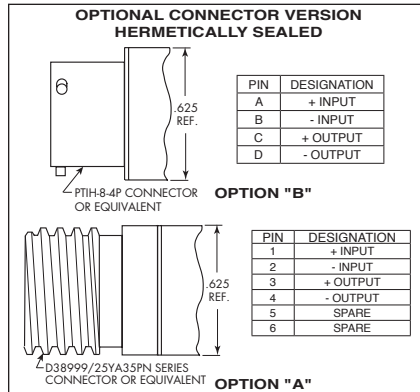

	1.7 25	3.5 50	7 100	17 BAR 250 PSI	35 500	70 1000	HKM 140 2000	210 3000	350 BAR 5000 PSI	
<b>INPUT</b>	Pressure Range									
	Operational Mode	Absolute	Absolute, Sealed Gage							
	Over Pressure	2 Times Rated Pressure to a Max. of 25000 PSI (1724 BAR)								
	Burst Pressure	3 Times Rated Pressure to a Max. of 25000 PSI (1724 BAR)								
	Pressure Media	All Nonconductive, Noncorrosive Liquids or Gases (Most Conductive Liquids and Gases-Consult Factory)				Any Liquid or Gas Compatible With 15-5 PH or 316 Stainless Steel				
	Rated Electrical Excitation	10 VDC								
	Maximum Electrical Excitation	12 VDC								
	Input Impedance	1000 Ohms (Min.)								
<b>OUTPUT</b>	Output Impedance	1000 Ohms (Nom.)								
	Full Scale Output	100 mV								
	Residual Unbalance	0 mV								
	Resolution	Infinitesimal								
<b>ENVIRONMENTAL</b>	Insulation Resistance	100 Megohm Min. @ 50 VDC								
	Operating Temperature Range	-65°F to +350°F (-55°C to +175°C)								
	Compensated Temperature Range	-65°F to +300°F (-55°C to +150°C)								
	Total Error Band	± 2% FSO +32°F to 180°F (0°C to +85°C) Increasing to ± 3% At All Other Temperatures Within The Compensated Range								
	Linear Vibration	20g Peak, Sine up to 2000 Hz								
	Altitude	-150 ft. to +70,000 ft. Will Not Damage Sensor								
<b>PHYSICAL</b>	Humidity	100% Relative Humidity								
	Mechanical Shock	20g half Sine Wave 11 msec. Duration								
	Electrical Connection	OPTION A: D38999/25YA35PN Connector or Equivalent, OPTION B: PTIH-8-4P Connector or Equivalent, OPTION C: 4 Conductor 24 AWG Shielded, Thermorad F Jacketed Cable, 40" (1 Meter)								
	Weight	17 Grams (Max.) Excluding Cable								
Pressure Sensing Principle	Fully Active Four Arm Wheatstone Bridge Dielectrically Isolated Silicon on Silicon (Patented Leadless Technology HKL Series)									
Mounting Torque	80 Inch-Pounds (Max.)									

Note: Custom pressure ranges, accuracies and mechanical configurations available. Dimensions are in inches. Dimensions in parenthesis are in millimeters. All dimensions nominal. (T) Continuous development and refinement of our products may result in specification changes without notice. Copyright © 2014 Kulite Semiconductor Products, Inc. All Rights Reserved.